

ONETORK





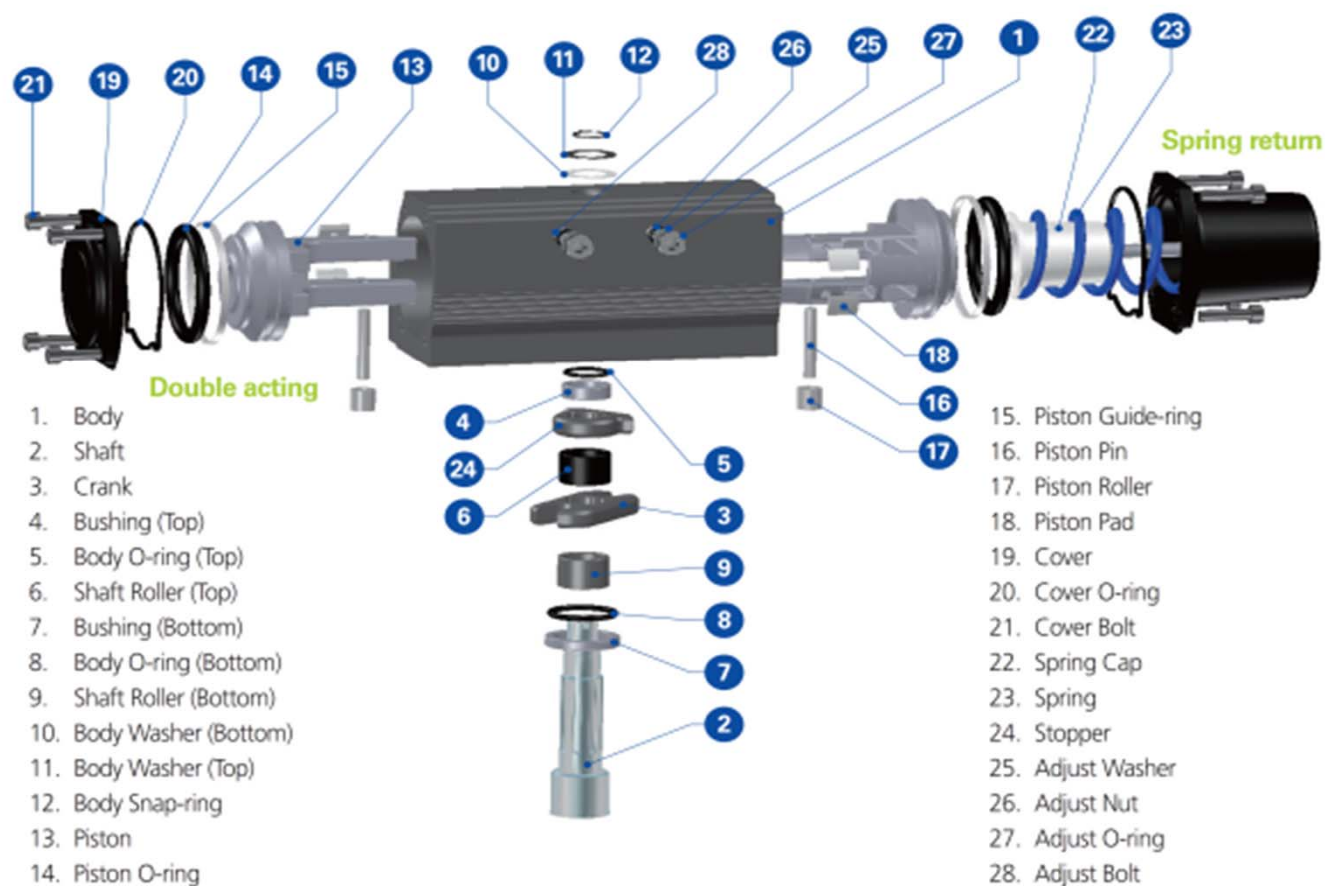

PNEUMATIC ACTUATOR

A series (scotch-yoke)

Part List

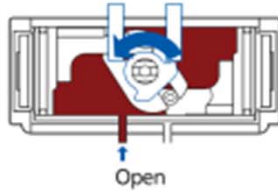
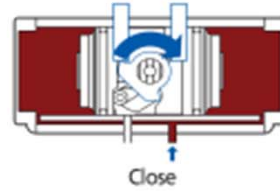

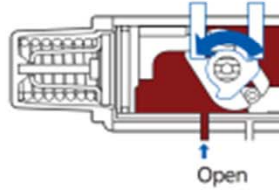
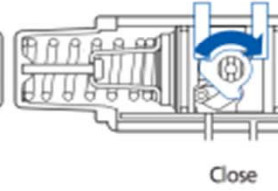
Operating Mechanism

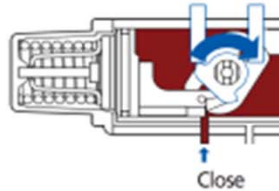
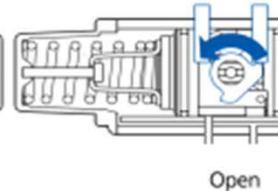
DOUBLE ACTING	Action "A" 	 Open	 Close	
	Action "A" (Fail Close) 	 Open	 Close	
SPRING RETURN	Action "B" (Fail Open) 	 Close	 Open	

Dimension table

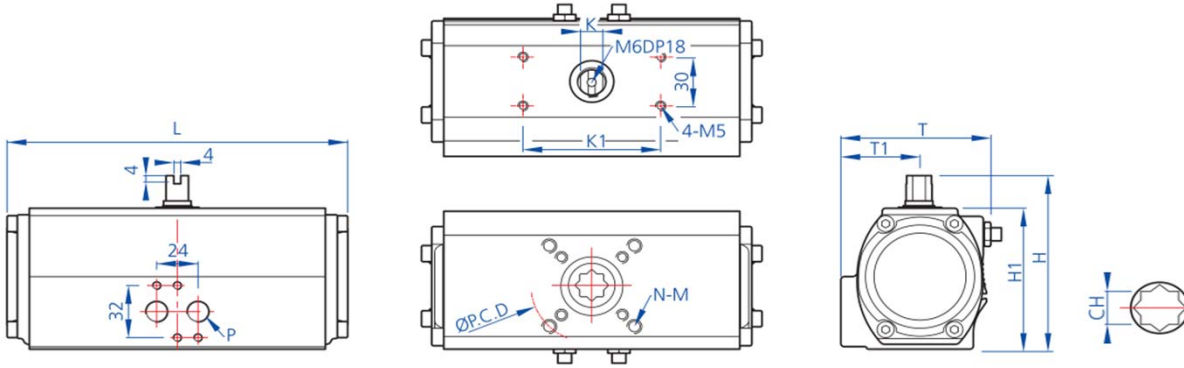

UNITS: INCHES / LBS

MODEL	K1	ISO	P.C.D (Ø)	N-M	K	L	T	T1	H	H1	CH	DEPTH	P	WEIGHT
OTD50	3.15	F05 / F07	1.97 / 2.76	4 - M6/M8	0.393	6.38	2.95	1.57	3.54	2.76	0.551	0.551	1/4" NPT	4
OTD65	3.15	F05 / F07	1.97 / 2.76	4 - M6/M8	0.512	7.95	3.5	1.81	4.21	3.43	0.551	0.669	1/4" NPT	6.5
OTD80	3.15	F07	2.76	4 - M8	0.669	10.32	3.98	1.95	4.96	4.17	0.669	0.75	1/4" NPT	10
OTD100	3.15	F07 / F10	2.76 / 4.02	4 - M8/M10	0.866	12.24	5.08	2.42	5.83	5.04	0.866	1.02	1/4" NPT	17
OTD125	3.15	F07 / F10	2.76 / 4.02	4 - M8/M10	0.866	15.35	5.95	2.81	6.85	6.06	0.866	1.02	1/4" NPT	26
OTD140	3.15	F10 / F12	4.02 / 4.92	4 - M10/M12	0.945	16.97	6.46	3.03	7.56	6.77	1.06	1.18	1/4" NPT	43
OTD160	3.15	F10 / F12	4.02 / 4.92	4 - M10/M12	1.26	19.92	7.41	3.51	8.5	7.72	1.41	1.18	1/4" NPT	60
OTD210	5.12	F16	6.5	4 - M20	1.42	23.82	9.09	4.53	11.18	10	1.81	2.36	1/4" NPT	107
OTD210D	5.12	F16	6.5	4 - M20	1.42	23.82	9.09	4.53	21.18	20	1.81	2.36	1/4" NPT	214

Torque table

MODEL	ANGLE	SUPPLY AIR					
		40 PSI		60 PSI		80 PSI	
		ATC	ATO	ATC	ATO	ATC	ATO
OTD50	0°	257	221	327	248	336	327
	45°	133	142	177	186	221	230
	90°	195	204	292	336	345	354
OTD65	0°	558	522	752	690	929	841
	45°	292	336	398	434	504	558
	90°	478	460	637	628	779	823
OTD80	0°	1,071	929	1,451	1,266	1,381	1,620
	45°	575	611	743	814	991	1,071
	90°	858	894	1,151	1,177	1,513	1,381
OTD100	0°	1,717	1,646	2,345	2,186	2,938	2,584
	45°	974	1,124	1,301	1,460	1,637	1,735
	90°	1,531	1,584	2,044	2,097	2,628	2,664
OTD125	0°	3,788	3,823	5,098	4,876	6,416	6,000
	45°	2,257	2,416	3,000	3,186	3,761	3,921
	90°	3,407	3,319	4,514	4,345	5,620	5,425
OTD140	0°	5,514	5,098	7,337	6,664	9,770	8,160
	45°	2,947	2,929	3,983	4,027	5,124	5,151
	90°	4,602	4,629	6,098	6,372	7,629	7,779
OTD160	0°	8,425	7,186	10,142	9,390	13,133	11,602
	45°	4,779	5,036	6,461	6,699	8,133	8,390
	90°	7,779	8,655	10,346	11,673	12,806	14,461
OTD210	0°	17,514	16,895	24,771	23,001	29,196	28,311
	45°	9,726	10,169	12,912	13,266	16,983	17,249
	90°	14,771	15,213	19,019	20,346	24,771	25,656
OTD210D	0°	35,028	33,789	49,542	46,002	58,392	56,622
	45°	19,452	20,337	25,824	26,532	33,966	34,497
	90°	29,541	30,426	38,037	40,692	49,542	51,312

Dimension table

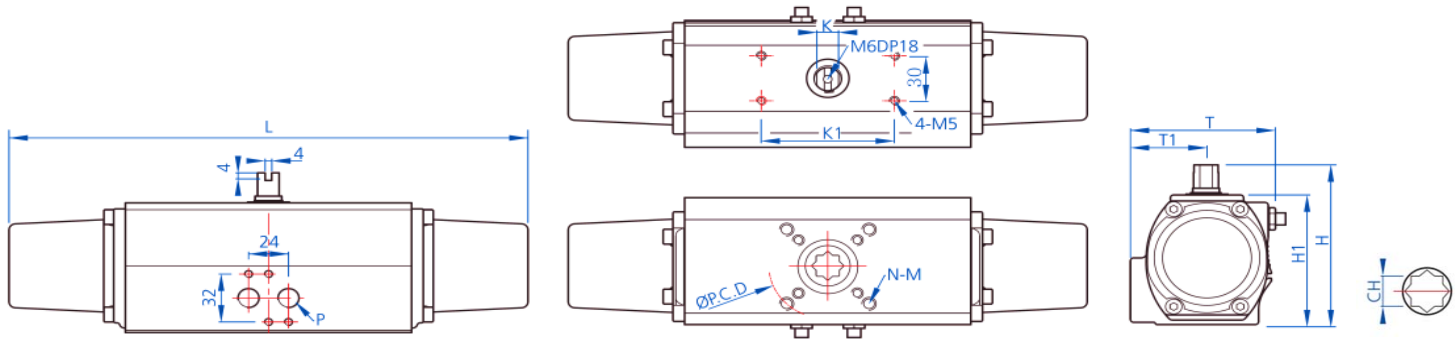

UNITS: INCHES / LBS

MODEL	K1	ISO	P.C.D (Ø)	N-M	K	L	T	T1	H	H1	CH	DEPTH	P	WEIGHT
OTS50	3.15	F05 / F07	1.97 / 2.76	4 - M6/M8	0.393	10.83	2.95	1.57	3.54	2.76	0.551	0.551	1/4" NPT	4.5
OTS65	3.15	F05 / F07	1.97 / 2.76	4 - M6/M8	0.512	12.38	3.5	1.81	4.21	3.43	0.551	0.669	1/4" NPT	8
OTS80	3.15	F07	2.76	4 - M8	0.669	16.93	3.98	1.95	4.96	4.17	0.669	0.75	1/4" NPT	13
OTS100	3.15	F07 / F10	2.76 / 4.02	4 - M8/M10	0.866	19.69	5.08	2.42	5.83	5.04	0.866	1.02	1/4" NPT	24
OTS125	3.15	F07 / F10	2.76 / 4.02	4 - M8/M10	0.866	23.86	5.95	2.81	6.85	6.06	0.866	1.02	1/4" NPT	41
OTS140	3.15	F10 / F12	4.02 / 4.92	4 - M10/M12	0.945	26.85	6.46	3.03	7.56	6.77	1.06	1.18	1/4" NPT	57
OTS160	3.15	F10 / F12	4.02 / 4.92	4 - M10/M12	1.26	30.75	7.41	3.51	8.5	7.72	1.41	1.18	1/4" NPT	83
OTS210	5.12	F16	6.5	4 - M20	1.42	38.66	9.09	4.53	11.18	10	1.81	2.36	1/4" NPT	172
OTS210D	5.12	F16	6.5	4 - M20	1.42	38.66	9.09	4.53	21.18	20	1.81	2.36	1/4" NPT	344

Torque table

MODEL	ANGLE	SUPPLY AIR					
		40 PSI		60 PSI		80 PSI	
		STC	ATO	STC	ATO	STC	ATO
OTS50	0°	89	177	124	230	150	301
	45°	80	80	106	106	133	133
	90°	177	89	230	124	301	150
OTS65	0°	195	345	310	478	425	620
	45°	159	159	204	248	327	283
	90°	345	195	478	310	620	425
OTS80	0°	354	620	531	885	708	1,151
	45°	266	266	443	443	620	620
	90°	620	354	885	531	1,151	708
OTS100	0°	620	1,239	885	1,682	1,151	2,124
	45°	443	443	708	708	974	974
	90°	1,239	620	1,682	885	2,124	1,151
OTS125	0°	1,328	2,213	2,036	3,363	2,655	4,514
	45°	1,151	1,151	1,682	1,682	2,301	2,301
	90°	2,213	1,328	3,363	2,036	4,514	2,655
OTS140	0°	1,770	3,275	2,655	4,868	3,629	6,461
	45°	1,505	1,505	2,567	2,567	3,009	3,009
	90°	3,275	1,770	4,868	2,655	6,461	3,629
OTS160	0°	3,540	4,779	4,868	6,638	6,806	10,169
	45°	2,567	2,567	3,717	3,717	4,956	4,956
	90°	4,779	3,540	6,638	4,868	10,169	6,806
OTS210	0°	5,930	10,611	9,284	14,328	12,558	19,196
	45°	4,956	4,956	8,310	8,310	11,142	11,142
	90°	10,611	5,930	14,328	9,284	19,196	12,558
OTS210D	0°	11,859	21,222	18,567	28,656	25,116	38,391
	45°	9,912	9,912	16,620	16,620	22,284	22,284
	90°	21,222	11,859	28,656	18,567	38,391	25,116

Adjustable Mechanical End Stops

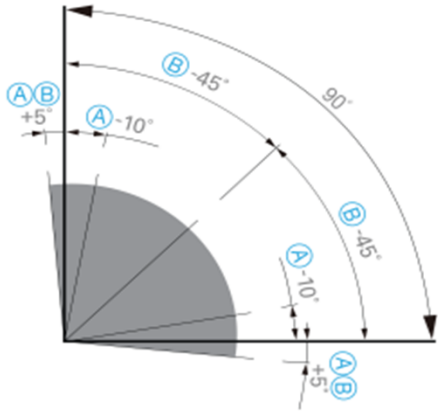
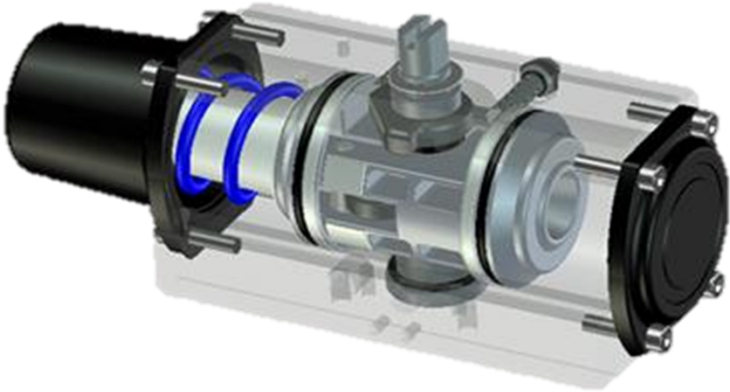

<p>(A) -STANDARD</p> <p>(B) -SPECIAL (OPTION)</p>	<p>KOSA+</p> <p>Angle range</p>	<p>+5°</p> <p>90° -10° (standard)</p> <p>-45° (option)</p>
---	--	--

NOTES:

Onetork Automation, Inc.
 27055 S. Ridge Road
 Elwood, IL 60421
sales@onetorkautomation.com
 Tel: 815-534-0505
 Fax: 815-669-1306